

KANSAS DEPT. OF WILDLIFE & PARKS

INFORMATION ON DISABILITY PERMITS ISSUED BY LAW ENFORCEMENT DIVISION

The following permit is issued to help assist the disabled. There is no charge for the permit but a big game permit and hunting and /or fishing license is still required unless exempt by Kansas law.

HUNT FROM A MOTOR VEHICLE PERMIT

HUNT FROM A MOTOR VEHICLE PROVISIONS:

As a disabled identification card holder you are allowed to hunt from a motorized vehicle without a department Hunt From A Motor Vehicle Permit. However, under the provisions set forth in K.S.A. 32-931 and K.A.R. 115-18-4 the following conditions shall apply.

(a) Your disability identification card shall not authorize any persons to shoot from any highway, as defined in K.S.A. 8-1424 (see back) and amendments thereto. K.S.A. 8-1424 defines a highway to mean the entire width between the boundary lines of every way publicly maintained when any part thereof is open to the public for purposes of vehicular travel.

(b) Disability cardholder is authorized to hunt wildlife during the prescribed open seasons from a stationary vehicle. This exemption does NOT apply to migratory game birds.

(c) You are not allowed to hunt on public lands where area regulations prohibit vehicles nor on privately owned lands where you do not have the landowner's permission.

(d) This permit does not waive requirements to possess the proper hunting licenses and permits and abide by applicable state and federal laws and regulations.

(e) These provisions are valid only for persons issued a Kansas disability identification card under provisions of K.S.A. 8-1,125(see back). Any person may assist a holder of such disability card to hunt from a vehicle during the card or permit holder's hunting activity. Any person assisting a holder of such disability card or permit shall not perform the actual shooting of wildlife for the disability cardholder.

(f) Your disability card is required to be carried when hunting and is to be displayed upon request of any Conservation Officer or law enforcement officer of this state.

(g) Your authorization to hunt from a stationary vehicle is valid for the state of Kansas. In order to hunt from a vehicle in another state, please contact the proper state wildlife department.

115-18-4. Permits for hunting from a vehicle; applications and requirements. (a) Any person with a disability as defined by K.S.A. 8-1,124, and amendments thereto, may apply to the secretary on forms provided by the department for a permit to hunt from a vehicle. Each applicant shall provide the following information:

- (1) Name of applicant;
- (2) address;
- (3) nature of the disability;

(4) a report signed by an authority as specified in K.S.A. 8-1,125 and amendments thereto, on forms provided by the department, that describes the disability and specifies the disability duration; and

(5) other information as required by the secretary.

(b) For any person with a disability to whom an individual identification card has been issued, as defined in and under the authority of K.S.A. 8-1,125 and amendments thereto, the individual identification card shall serve as a permit to hunt from a vehicle. An individual identification card shall not be used as a permit to hunt from a vehicle under any of the following conditions:

(1) The individual identification card is no longer valid.

(2) The individual identification card was obtained through false pretenses.

(3) The disability for which the individual identification card was issued no longer exists.

(c) The permittee shall be in possession of the permit while hunting.

(d) The permit shall be valid statewide and only for the person to whom the permit was issued.

(e) The permit shall be valid for the time period specified in the permit as determined by the permanent or temporary nature of the disability.

(f) The holder of a permit to hunt from a vehicle may shoot from a nonmoving vehicle, but only in compliance with applicable state and federal laws and regulations.

(g) A permit for hunting from a vehicle may not be issued or may be revoked by the secretary for any of the following reasons:

(1) The disability does not meet the qualifications for the permit.

(2) The application is incomplete or contains false information.

(3) The disability under which the permit was issued no longer exists.

If the secretary revokes a person's permit for any of the above reasons, then that person shall not use an individual identification card as a permit to hunt from a vehicle.

(h) Any person may assist the holder of a permit to hunt from a vehicle during the permit holder's hunting activity. A person assisting a holder of this permit shall not perform the actual shooting of wildlife for the permit holder. (Authorized by and implementing K.S.A. 32-931; effective Oct. 30, 1989; amended Nov. 15, 1993; amended October 1, 1999.)

8-1,124. Accessible parking, definition. As used in this act, "person with a disability" means any individual who:

(a) Has a severe visual impairment;

(b) cannot walk 100 feet without stopping to rest;

(c) cannot walk without the use of or assistance from, a brace, cane, crutch, another person, prosthetic device, wheelchair or other assistive device;

(d) is restricted by lung disease to such an extent that the person's forced (respiratory) expiratory volume for one second, when measured by spirometry, is less than one liter or the arterial oxygen tension is less than 60 mm/hg on room air at rest;

(e) uses portable oxygen;

(f) has a cardiac condition to the extent that the person's functional limitations are classified in severity as class III or class IV according to standards set by the American heart association; or

(g) is severely limited in such person's ability to walk at least 100 feet due to an arthritic, neurological or orthopedic condition.

History: L. 1986, ch. 36, § 1; L. 1987, ch. 44, § 1; L. 1988, ch. 45, § 1; L. 1991, ch. 35, § 2; L. 1992, ch. 105, § 11; L. 1999, ch. 68, § 1; July 1.

8-1,125. License plates, placards and individual identification cards for persons with disability; penalty. (a) Any Kansas resident who submits satisfactory proof to the director of vehicles, on a form provided by the director, that such person is a person with a disability or is responsible for the transportation of a person with a disability shall be issued a special license plate or a permanent placard for any motor vehicle owned by such person or shall be issued a temporary placard. Satisfactory proof of disability, condition or impairment shall include a statement from a person licensed to practice the healing arts in any state, a licensed optometrist, an advanced registered nurse practitioner registered under K.S.A. 65-1131, and amendments thereto, a licensed physician assistant or a Christian Science practitioner listed in The Christian Science Journal certifying that such person is a person with a disability. The placard shall be suspended immediately below the rear view mirror of any motor vehicle used for the transportation of a person with a disability so as to be maximally visible from outside the vehicle. In addition to the special license plate or permanent placard, the director of vehicles shall issue to the person with a disability an individual identification card which must be carried by the person with a disability when the motor vehicle being operated by or used for the transportation of such person is parked in accordance with the provisions of K.S.A. 8-1,126, and amendments thereto. In addition to the temporary placard, a person issued such temporary placard shall carry the state or county receipt showing the name of the person who is issued such temporary placard. A person submitting satisfactory proof that such person's disability, condition or impairment is permanent in nature, and upon such person's request and payment of the fees prescribed in subsection (b), shall be issued a permanent placard or a permanent placard and a special license plate and an individual identification card. Upon proper request, one additional permanent placard shall be issued to the applicant who has not requested and received a special license plate. Upon proper request, one additional temporary placard shall be issued to the applicant certified as temporarily disabled. Temporary placards shall have an expiration date of not longer than six months from the date of issuance. The special license plates and placards shall display the international symbol of access to the physically disabled.

(b) Special license plates issued pursuant to this section shall be issued for the same period of time as other license plates are issued or for the remainder of such period if an existing license plate is to be exchanged for the special license plate. There shall be no fee for such special license plates in addition to the regular registration fee. No person shall be issued more than one special license plate, except that agencies or businesses which provide transportation for persons with a disability as a service, may obtain additional special license plates for vehicles which are utilized in the provision of that service. Special license plates may be personalized license plates subject to the provisions of K.S.A. 8-132, and amendments thereto, including the payment of the additional fee.

(c) Except as otherwise provided in this section, placards and individual identification cards issued pursuant to this section shall be issued for such period of time as the person to

whom issued continues to be a person with a disability or a person responsible for the transportation of a person with a disability, except that the secretary of revenue shall make a determination of continued eligibility for a special license plate or placard at least every three years from the original date of issuance of such license plate and placard.

(d) On and after July 1, 1992, the color of the permanent placard shall be white on a blue background and the temporary placard shall be white on a red background.

(e) In addition to such other information contained on identification cards, cards issued or reissued on and after July 1, 2000, shall have the date of birth and the sex of the person to whom the card is issued.

(f) Permanent placards and individual identification cards shall be returned to the department of revenue upon the death of the person with a disability. Temporary placards shall be returned to the department of revenue upon the expiration of the placard or upon the death of the person with a disability. Special license plates shall be returned to the county treasurer to be exchanged for another license plate upon the death of the person with a disability. The individual identification cards issued with the special license plates shall be returned to the department of revenue upon the death of the person with a disability.

(g) Violation of subsection (f) is an unclassified misdemeanor punishable by a fine of not more than \$50.

History: L. 1986, ch. 36, § 2; L. 1987, ch. 44, § 2; L. 1988, ch. 45, § 2; L. 1991, ch. 35, § 3; L. 1992, ch. 105, § 12; L. 1995, ch. 186, § 5; L. 1999, ch. 68, § 2; L. 2002, ch. 70, § 2; July 1.

8-1424. AHighway@ defined. AHighway@ means the entire width between the boundary lines of every way publicly maintained when any part thereof is open to the use of the public for purposes of vehicular travel.

History: L. 1974, ch. 33, ' 8-1424; July 1.

NO FEE

KANSAS DEPARTMENT OF WILDLIFE AND PARKS

A KANSAS RESIDENT POSSESSING A HANDICAPPED IDENTIFICATION CARD MAY USE IT IN LIEU OF A HUNT FROM A VEHICLE PERMIT.

Name _____

Address _____

City _____ State _____ Zip _____

Telephone: _____ SS#: _____

Date of Birth: _____ Driver's License or ID Card Number: _____

What is your disability? _____

(PLEASE SEE BACK OF APPLICATION FOR DEFINITION)

HEALING ARTS LICENSED PROFESSIONAL'S STATEMENT

Attending licensed professional must certify and sign the following:

I, the undersigned licensed professional, certify that (Disabled Individuals's Name) _____ is considered to be disabled, as per Kansas Statute 8-1, 124, due to at least one (1) or more of the following: (Must check at least one.)

- 1. Has a severe visual impairment;
2. Cannot walk one hundred (100) feet without stopping to rest (Violation KSA 8-1, 130);
3. Cannot walk without the use of or assistance from, a brace, cane, crutch, another person, prosthetic device, wheelchair, or other assistive device;
4. Is restricted by lung disease to such an extent that the person's forced (respiratory) expiratory volume for one second, when measured by spirometry, is less than one liter, or the arterial oxygen tension is less than sixty mm/hg on room air at rest;
5. Uses portable oxygen;
6. Has a cardiac condition to the extent that the person's functional limitations are classified in severity as Class III or Class IV according to standards set by the American Heart Association;
7. Severely limited in their ability to walk at least 100' due to an arthritic, neurological, or orthopedic condition.

I certify that I am aware of the penalties provided by KSA 8-1,130(a)(b) listed on the back of this application.

Licensed Professional's Signature* (Rubber stamp not acceptable) Medical Title Date

* The following are the only professionals that can sign this form: Dr. of Medicine (MD), Dr. of Osteopathy (DO), Dr. of Chiropractic (DC), Dr. of podiatric (DPM), Licensed Optometrist (OD), licensed physician assistant (PA), advanced registered nurse practitioner (ARNP) registered under KSA65-1131 or ChristianScience practitioner listed in the ChristianScienceJournal(KSA Chapter 65, Article 28 and 8-1,125)

MUST check one (1) of the below and provide requested information:

- TEMPORARY** -> FROM (DATE) _____ TO (DATE) _____ PERMANENT
** Six (6) Months is the MAXIMUM Duration for a Temporary Placard.

Printed/Typed Name of Licensed Professional _____ Phone No. _____

May be signed by a Healing Arts Professional licensed in any state.

Printed: Address City State Zip

PLEASE SEND COMPLETED APPLICATION TO: KS Dept. of Wildlife & Parks Reg 2 300 SW Wanamaker Topeka, KS 66606 Phone - 785-273-6740 FAX - 785-273-6757

Or Regional office in which you reside. See listing on next page.

K.A.R. 115-18-4 (a) any person with a disability as defined by K.S.A. 8-1, 124 and amendments thereto, may apply to the secretary on forms provided by the department for a permit to hunt from a vehicle.

K.S.A. 8-1, 124 defines a disability as an individual whom:

- a) has severe visual impairment
- b) cannot walk 100 feet without stopping to rest
- c) cannot walk without the use of or assistance from, a brace, cane, crutch, another person, prosthetic device, wheelchair or other assistive device;
- d) is restricted by lung disease to such an extent that the person's forced (respiratory) expiratory volume for one second, when measured by spirometry, is less than one liter or the arterial oxygen tension is less than 60 mm/hg on room air at rest;
- e) uses portable oxygen;
- f) has a cardiac condition to the extent that the person's functional limitations are classified in severity as class III or class IV according to standards set by the American Heart Association; or;
- g) is severely limited in such person's ability to walk due to an arthritic, neurological or orthopedic condition.

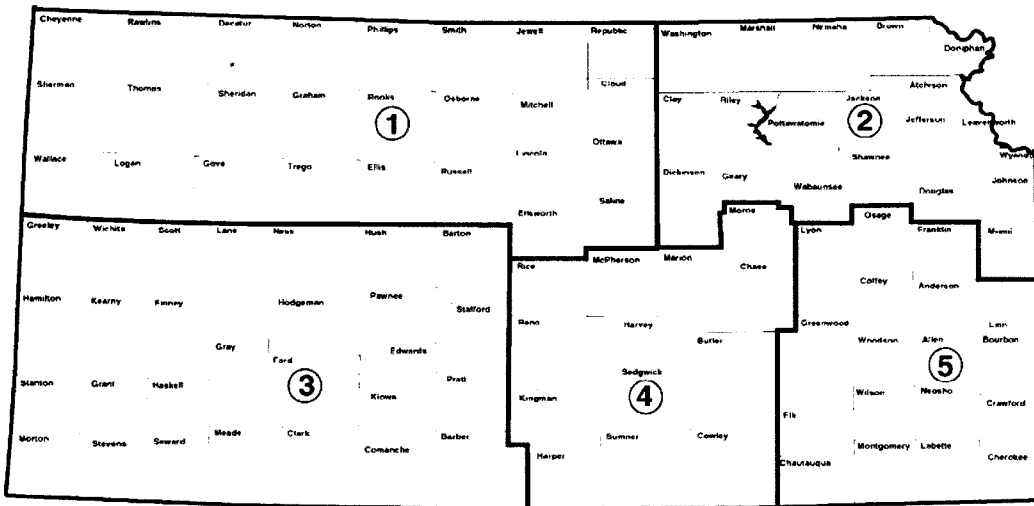

REGION 1:
PO BOX 338
1426 HWY. 183 ALT.
HAYS, KS 67601
(785)628-8614

REGION 2:
300 SW Wanamaker
TOPEKA, KS 66602
(785)273-6740

REGION 3:
1001 W. MCARTOR
DODGE CITY, KS 67801
(620)227-8609

REGION 4:
6232 E. 29TH ST. N.
WICHITA, KS 67220
(316)683-8069

REGION 5:
1500 W. 7TH
PO BOX 777
CHANUTE, KS 66720 (620)431-0380